

GREY IRON (GI)

Capacities to 4,000 lbs.

Standard Features

- **Composition** - Heavy SAE G3000 grey iron castings
- **Extra Thick Rim & Cross Sections**
- **Zerk Fitting In Hub** - (Except 4" x 2", must lubricate through axle)
- **Machined Face**
- **Tensile Strength** - 30,000 PSI
- **Solid Core/No Spokes** - (Except 8" x 3" and 10" x 3")



GI42R-12

APPLICATIONS:

Close grained grey iron castings eliminates porosity or blow holes.

Ideally suited for high capacity requirements where the addition of shock or impact loads may cause standard cast iron wheels to crack or break.

Optional Features

- **Roller Bearing Seals** - (Suffix -SW)
- **Tapered Bearing Seals** - Consult factory

Dia. Inches (mm)	Tread Width Inches (mm)	Hub Length Inches (mm)	Load Capacity lbs. (KGS)	Wt. lbs. (KGS)	Plain Bore or Bore Less		Roller Bearing		Tapered Roller Bearing	
					Part No.	Sizes	Part No.	Sizes	Part No.	Sizes
4 (102)	2 (50)	2 1/4 (57)	1000 (450)	4.5 (2.0)	GI42-19	1 3/16	GI42R-12	3/4	—	—
5 (127)	2 (50)	2 1/4 (57)	1300 (585)	6 (2.7)	GI52-19	1 3/16	GI52R-12	3/4	—	—
6 (152)	2 (50)	2 1/4 (57)	1600 (720)	7 (3.0)	GI62-19	1 3/16	GI62R-12	3/4	GI62T-12	3/4
	2 1/2 (64)	2 3/4 (70)	3000 (1350)	11 (5.0)	GI625-25	1 9/16	GI625R-16	1	GI625T-12	3/4
	3 (76)	3 1/4 (83)	3100 (1395)	12 (5.5)	GI63-29	1 13/16	GI63R-16	1	GI63T-12	3/4
8 (203)	2 (50)	2 1/4 (57)	1800 (810)	8.5 (4.0)	GI82-19	1 3/16	GI82R-12	3/4	—	—
	2 1/2 (64)	2 3/4 (70)	3100 (1395)	17 (8.0)	GI825-25	1 9/16	GI825R-16	1	GI825T-12	3/4
	3 (76)	3 1/4 (83)	4000 (1800)	18 (8.5)	GI83-29	1 13/16	GI83R-16	1	GI83T-20	1 1/4
10 (254)	2 1/2 (64)	2 3/4 (70)	3300 (1485)	22 (10.0)	GI1025-31	1 15/16	GI1025R-16	1	GI1025T-12	3/4
	3 (76)	3 1/4 (83)	4000 (1800)	24 (11.0)	GI103-29	1 13/16	GI103R-16	1	GI103T-20	1 1/4

Note: Standard bearing size is called out in last two digits of part number in sixteenths (ie. GI63R-16 = 1" bearing, GI63R-20 = 1 1/4" bearing). For smaller bore refer to spanner bushings in component parts selection (page 52).

HEAVY DUTY DUCTILE IRON (HD)

Capacities to 10,000 lbs.

Standard Features

- **Construction** - Heavily sectioned rims and solid web
- **Tapered Roller Bearings**
- **Zerk Fitting On Hub**



HD83T-20

APPLICATIONS:

Heavily sectioned rims and solid web design ensures long service life in the most severe of applications.

Dia. Inches (mm)	Tread Width Inches (mm)	Hub Length Inches (mm)	Load Capacity lbs. (KGS)	Wt. lbs. (KGS)	Tapered Roller Bearing	
					Part No.	Sizes
8 (203)	3 (76)	3 1/4 (83)	10000 (4500)	26 (12)	HD83T-20	1 1/4
10 (254)	3 (76)	3 1/4 (83)	10000 (4500)	37 (17)	HD103T-20	1 1/4

CAST IRON (SS)

Capacities to 3,500 lbs.

Standard Features

- **Composition** - Cast Iron also known as "Semi-Steel" due to the content of steel in the iron
- **Cast Iron Wheels Provide** - High capacities coupled with exceptional service life
- **Highest Of Temperature Ranges**
- **Machined Faces** - For a smooth, concentric rolling surface, offered in most sizes shown

Options Available

- **Roller Bearing Seals** - (Suffix -SW)
- **Tapered Bearing Seals** - Consult factory
- **Spanner Bushings** - See page 52
- **Special Bore Sizes, Keyways, Set Screws** - (Price on appl.)



SS62R-12

APPLICATIONS:
High capacity requirements where floor protection is not a concern.

2" and 2 1/2" wide wheels not recommended where possibility exists for extreme shock or impact under load. Excellent where load sits static for long periods.



Sintered Iron Wheel
SI314P-06

Dia. Inches (mm)	Tread Width Inches (mm)	Hub Length Inches (mm)	Load Capacity lbs. (KGS)	Wt. lbs. (KGS)	Plain Bore or Bore Less Roller Bearings		Roller Bearing		Tapered Roller Bearing	
					Part No.	Sizes	Part No.	Sizes	Part No.	Sizes
2 (50)	1 (25)	1 1/64 (26)	150 (67)	0.5 (.2)	SI20P-04*	1/4	—	—	—	—
2 1/2 (60)	1 1/8 (28)	1 3/8 (35)	200 (90)	0.8 (.4)	SI25P-05*	5/16	—	—	—	—
3 (76)	1 5/16 (33)	1 9/16 (40)	300 (135)	1.1 (.5)	SI314P-06*	3/8	—	—	—	—
	1 1/4 (32)	1 9/16 (40)	300 (135)	1.2 (.5)	SS314P-08	1/2	SS314R-08†*	1/2	—	—
3 1/4 (83)	1 1/2 (38)	1 5/8 (41)	400 (180)	3.2 (1.4)	SS31-19	1 3/16	SS31R-12	1/2, 5/8, 3/4	—	—
	2 (50)	2 3/16 (56)	500 (270)	3.3 (1.4)	SS32-19	1 3/16	SS32R-12	1/2, 5/8, 3/4	—	—
3 1/2 (89)	1 1/4 (32)	1 1/2 (38)	350 (157)	1.4 (.6)	SS3514P-08	1/2	SS3514R-08	1/2	—	—
	1 1/4 (32)	1 1/2 (38)	500 (225)	1.5 (.7)	SS414P-08	1/2	SS414R-08†*	1/2	—	—
4 (102)	1 1/2 (38)	1 15/16 (49)	450 (202)	2.6 (1.2)	SI415P-07*	7/16	—	—	—	—
	1 1/2 (38)	1 5/8 (41)	550 (248)	2.6 (1.2)	SS41-19	1 3/16	SS41R-12	1/2, 5/8, 3/4	—	—
	2 (50)	2 3/16 (56)	700 (315)	2.7 (1.2)	SS42-19	1 3/16	SS42R-12	1/2, 5/8, 3/4	—	—
5 (127)	1 1/4 (32)	1 1/2 (38)	500 (225)	1.9 (.9)	SS514P-08	1/2	SS514R-08	1/2	—	—
	1 1/2 (38)	1 5/8 (41)	600 (270)	2.8 (1.2)	SS51-19	1 3/16	SS51R-12	1/2, 5/8, 3/4	—	—
	2 (50)	2 3/16 (56)	900 (405)	3.0 (1.4)	SS52-19	1 3/16	SS52R-12	1/2, 5/8, 3/4	—	—
	2 1/2 (60)	3 1/4 (83)	2500 (1125)	8.5 (3.8)	SS525-31*	1 15/16	SS525R-16*	1, 1 1/4	SS525T-12*	3/4, 1
	3 (76)	3 1/4 (83)	1500 (675)	9.3 (4.2)	SS53-31*	1 15/16	SS52R-16*	1, 1 1/4	SS53T-12*	3/4, 1, 1 1/4

Dia. Inches (mm)	Tread Width Inches (mm)	Hub Length Inches (mm)	Load Capacity lbs. (KGS)	Wt. lbs. (KGS)	Plain Bore or Bore Less Roller Bearing		Roller Bearing		Tapered Roller Bearing	
					Part No.	Sizes	Part No.	Sizes	Part No.	Sizes
6 (152)	1 1/2 (38)	1 1/2 (41)	600 (270)	3.8 (1.7)	SS61-19	1 3/16	SS61R-12	1/2, 5/8, 3/4	—	—
	2 (50)	2 3/16 (56)	1000 (450)	5.2 (2.3)	SS62-19	1 3/16	SS62R-12	1/2, 5/8, 3/4	SS62T-12	3/4
	2 1/2 (60)	2 3/4 (70)	1800 (810)	6.3 (2.8)	SSS625-31	1 15/16	SSS625R-16	1, 1 1/4	SSS625T-12†	3/4
	2 1/2 (60)	3 1/4 (83)	2200 (990)	6.8 (3.1)	SS625-31	1 15/16	SS625R-16	1, 1 1/4	SS625T-12†	3/4
	3 (76)	3 1/4 (83)	2500 (1125)	7.0 (3.1)	SS63-31	1 15/16	SS63R-16	1, 1 1/4	SS63T-12†	3/4, 1, 1 1/4
7 (178)	2 (50)	2 1/2 (57)	1000 (450)	7.0 (3.1)	SS72-19*	1 3/16	SS72R-12	3/4, 7/8, 1	—	—
	2 1/2 (60)	3 1/4 (83)	1500 (675)	11.7 (5.3)	SS725-31	1 15/16	SS725R-16	1, 1 1/4	—	—
	3 (76)	3 1/4 (83)	3000 (1350)	14.0 (6.3)	SS73-31*	1 15/16	SS73R-16	3/4, 1, 1 1/4	SS73T-12	3/4, 1, 1 1/4
8 (203)	2 (50)	2 3/16 (56)	1000 (450)	7.5 (3.4)	SS82-19	1 3/16	SS82R-12	1/2, 5/8, 3/4	—	—
	2 1/2 (60)	2 3/4 (70)	2200 (990)	9.3 (4.2)	SSS825-31	1 15/16	SSS825R-16	1, 1 1/4	—	—
	2 1/2 (60)	3 1/4 (83)	2500 (1125)	11.0 (5.0)	SS825-31	1 15/16	SS825R-16	1, 1 1/4	SS825T-12†	3/4, 1, 1 1/4
	3 (76)	3 1/4 (83)	2500 (1125)	11.5 (5.1)	SS83-31	1 15/16	SS83R-16	1, 1 1/4	SS83T-12	3/4, 1, 1 1/4
	4 (102)	4 1/4 (108)	3500 (1575)	28.0 (12.6)	SS84-39*	2 7/16	SS84R-20*	1, 1 1/4	SS84T-20*	1, 1 1/4
10 (254)	2 1/2 (60)	2 3/4 (70)	2000 (900)	13.0 (5.9)	SSS1025-31	1 15/16	SSS1025R-16	1, 1 1/4	—	—
	2 1/2 (60)	3 1/4 (83)	2500 (1125)	17.0 (7.7)	SS1025-31	1 15/16	SS1025R-16	1, 1 1/4	SS1025T-12	3/4, 1, 1 1/4
	3 (76)	3 1/4 (83)	2500 (1125)	18.3 (8.2)	SS103-31	1 15/16	SS103R-16	1, 1 1/4	SS103T-12	3/4, 1, 1 1/4
	3 1/2 (89)	4 1/4 (108)	3000 (1350)	22.0 (9.9)	SS1035-31	1 15/16	SS1035R-20	1, 1 1/4	SS1035T-16	1, 1 1/4
	4 (102)	4 1/4 (108)	3000 (1350)	24.0 (10.8)	SS104-39	2 7/16	SS104R-20	1, 1 1/4	SS104T-20	1 1/4
12 (305)	2 1/2 (60)	2 3/4 (70)	1800 (810)	20.0 (9.0)	SSS1225-31	1 15/16	SSS1225R-16	1, 1 1/4	—	—
	3 (76)	3 1/4 (83)	2500 (1125)	25.0 (11.2)	SS123-31	1 15/16	SS123R-16	1, 1 1/4	SS123T-12	3/4, 1, 1 1/4
	3 1/2 (89)	4 1/4 (108)	2100 (945)	27.0 (12.2)	SS1235-39	2 7/16	SS1235R-20	1 1/4, 1 1/2	—	—
	4 (102)	4 1/4 (108)	2000 (900)	28.0 (12.6)	SS125-39	2 7/16	SS125R-20	1 1/4, 1 1/2	—	—
14 (356)	2 1/2 (60)	2 3/4 (70)	1700 (765)	17.0 (7.7)	SSS1425-31	1 15/16	SSS1425R-16	1, 1 1/4	—	—
	3 (76)	3 1/4 (83)	1800 (810)	24.0 (10.8)	SS143-31	1 15/16	SS143R-16	1, 1 1/4	—	—
16 (406)	2 1/2 (60)	3 1/4 (83)	1700 (765)	22.0 (9.9)	SS1625-31	1 15/16	SS1625R-16	1, 1 1/4	—	—
	3 (76)	3 1/4 (83)	1850 (830)	30.0 (13.5)	SS163-31	1 15/16	SS163R-16	1, 1 1/4	SS163T-12	3/4, 1, 1 1/4
	3 1/2 (89)	4 1/4 (108)	1900 (855)	34.0 (15.3)	SS1635-39	2 7/16	SS1635R-20	1 1/4, 1 1/2	—	—
18 (457)	2 1/2 (60)	3 1/4 (83)	1800 (810)	27.0 (12.2)	SS1825-31	1 15/16	SS1825R-16	1, 1 1/4	—	—
	3 (76)	4 1/4 (108)	1900 (855)	34.0 (15.3)	SS183-39	2 7/16	SS183R-20	1 1/4, 1 1/2	SS183T-20	1 1/4

• These wheels are Sintered Iron (Powdered iron, compacted and sintered to cast iron strength).

† Tread as cast (not machined face)

* Solid Core (no spokes)

Note: Standard bearing size is called out in last two digits of part number in sixteenths (ie. SS63R-**16** = 1" bearing, SS63R-**20** = 1 1/4" bearing).
For smaller bore refer to spanner bushings in component parts selection (page 52).

FORGED STEEL (FS)

Capacities to 15,000 lbs.

Standard Features

- **Tensile Strength** - 68,000 PSI min.
- **Machined Face**
- **Zerk Fitting In Hub**
- **Composition** - 1030 or 1045 drop forged steel



FS62R-12

APPLICATIONS:

Used where highest capacity is required and floor protection is not a factor.

Offers by far the longest service life.

Optional Features

- **Roller Bearing Seals** - (Suffix **-SW**)
- **Tapered Bearing Seals** - Consult factory
- **Other Sizes Available**

Dia. Inches (mm)	Tread Width Inches (mm)	Hub Length Inches (mm)	Load Capacity lbs. (KGS)	Wt. lbs. (KGS)	Plain Bore or Bore Less Roller Bearing		Roller Bearing		Tapered Roller Bearing	
					Part No.	Sizes	Part No.	Sizes	Part No.	Sizes
4 (102)	1 1/2 (38)	2 3/16 (56)	1400 (630)	3.25 (1.5)	FS41-19	1 3/16	FS41R-12	3/4	FS41T-08	1/2
5 (127)	2 (50)	2 3/16 (56)	1500 (675)	5.25 (2.4)	FS52-19	1 3/16	FS52R-12	3/4	FS52T-08	1/2
6 (152)	2 (50)	2 3/16 (56)	1500 (675)	6.25 (2.8)	FS62-19	1 3/16	FS62R-12	3/4	FS62T-08	1/2
	2 1/2 (60)	3 1/4 (83)	4000 (1800)	11.75 (5.3)	FS625-31	1 15/16	FS625R-16	1, 1 1/4	FS625T-12	3/4, 1
	3 (76)	3 1/4 (83)	5500 (2500)	20.0 (9.0)	FS63-39	2 7/16	FS63R-16	1, 1 1/4	—	—
	3 (76)	3 1/2 (89)	10,000 (4500)	20.0 (9.0)	—	—	—	—	FS63T-20	1 1/4, 1 1/2
8 (203)	2 1/2 (60)	3 1/4 (83)	4000 (1800)	18.5 (8.5)	FS825-31	1 15/16	FS825R-16	1, 1 1/4	—	—
	3 (76)	3 1/4 (83)	4500 (2000)	19.0 (8.6)	FS83-31	1 15/16	FS83R-16	1, 1 1/4	—	—
	3 (76)	3 1/2 (89)	5500 (2500)	19.0 (8.6)	—	—	—	—	FS83T-12	—
	4 (102)	4 1/2 (108)	8350 (3800)	35.5 (16.0)	FS84-39	2 7/16	FS84R-20	1 1/4, 1 1/2	—	—
	4 (102)	4 1/2 (114)	10,000 (4500)	36.5 (16.5)	—	—	—	—	FS84T-16	1, 1 1/4
10 (254)	3 (76)	3 1/4 (83)	5000 (2200)	28.0 (12.7)	FS103-31	1 15/16	FS103R-16	1, 1 1/4	FS103T-12	3/4, 1, 1 1/4
	4 (102)	4 1/4 (108)	8350 (3800)	48.0 (21.8)	FS104-39	2 7/16	FS104R-20	1 1/4, 1 1/2	—	—
	4 (102)	4 1/2 (114)	10,000 (4500)	48.0 (21.8)	—	—	—	—	FS104T-16	1, 1 1/4

Note: Standard bearing size is called out in last two digits of part number in sixteenths (ie. FS63R-16 = 1" bearing, FS63R-20 = 1 1/4" bearing). For smaller bore refer to spanner bushings in component parts selection (page 52).

V-GROOVED (VG)

Capacities to 15,000 lbs.

Standard Features

- **Machined Face**
- **Relief Groove** - Assures correct weight distribution and makes the wheel self cleaning
- **Available In Both Cast Iron And Drop Forged** - (VG-Cast Iron, VF-Drop Forged)

Optional Features

- **Keyways, Set Screws**
- **Special Bore Sizes**
- **Sealed Bearings**- (Suffix-SW)
- **Stainless Steel**- (Consult Factory)

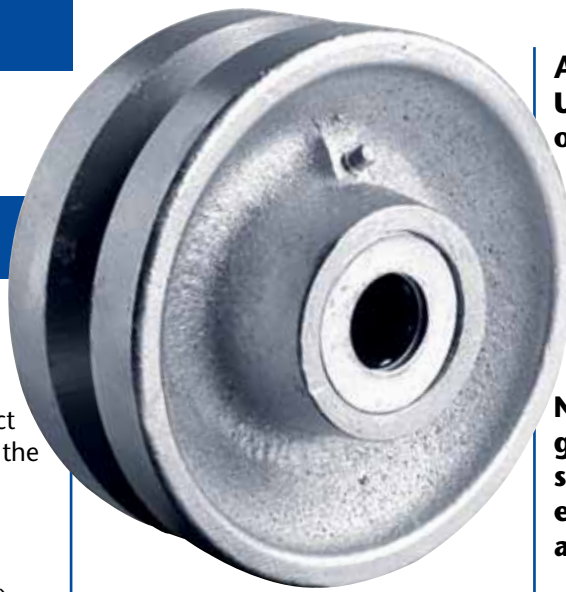

S562R-KT

In heavier applications, consider running V-grooved on one side, flat face on opposite side. In these cases, angle track may be tack welded to flat steel plate bolted to floor. Care should be taken in adjusting heights on both sides. Flat face wheels may run on flat steel track elevated accordingly.

APPLICATIONS:
Used in tracking application of all types where free flow is desired.

Suggested that 1 1/2" and 2" face wheels run on 1 1/2" and 1 1/2" angle iron. 2 1/2" face wheels or wider should run on 2"x2" angle.

Note that when running grooved wheels on both sides, care must be taken to ensure tracks are parallel to avoid binding.



Wheel Specifications						Roller Bearing		Tapered Roller Bearing		
Dia. Inches (mm)	Tread Width Inches (mm)	Hub Length Inches (mm)	Load Capacity lbs. (KGS)	Approx. Shipping Wt. lbs. (KGS)	Groove Dimensions Inches		Sizes Inches	Part Number	Sizes Inches	Part Number
					Width	Depth				
4 (102)	1 1/2 (37)	1 5/8 (41)	600 (270)	4.0 (1.8)	7/8	7/16	1/2, 5/8, 3/4	VG41R-12	—	—
	2 (55)	2 3/16 (55)	800 (360)	4.0 (1.8)	7/8	7/16	1/2, 5/8, 3/4	VG42R-12	—	—
5 (127)	2 (50)	2 3/16 (55)	800 (360)	5.0 (2.3)	7/8	7/16	1/2, 5/8, 3/4	VG52R-12	—	—
6 (152)	2 (50)	2 3/16 (55)	1000 (450)	7.0 (3.2)	7/8	7/16	1/2, 5/8, 3/4	VG62R-12	—	—
	2 1/2 (60)	2 3/4 (69)	1600 (720)	9.5 (4.3)	7/8	7/16	1, 1 1/4	VG625R-16	—	—
	2 1/2 (69)	3 1/4 (82)	2500 (1125)	15.0 (7.0)	7/8	7/16	1, 1 1/4	VG63R-16	1, 1 1/4	VG63T-16
	3 (76)	3 1/4 (83)	6000 (2,700)	20.3 (9.1)	1 3/8	11/16	1 1/4, 1 1/2	VF63R-20	1, 1 1/4	VF63T-16
8 (203)	2 1/2 (60)	2 3/4 (69)	1800 (810)	16.0 (7.2)	7/8	7/16	1, 1 1/4	VG825R-16	—	—
	2 1/2 (60)	3 1/4 (82)	2500 (1125)	17.0 (7.8)	7/8	7/16	1, 1 1/4	VG83R-16	1, 1 1/4	VG83R-16
	4 (102)	4 1/4 (107)	8350 (3800)	30.0 (13.5)	1 3/4	7/8	1, 1 1/4	VF84R-20	1 1/4	VF84T-20
10 (254)	3 (76)	3 1/4 (41)	3000 (1350)	30.0 (13.5)	1 3/8	11/16	1, 1 1/4	VG103R-12	3/4, 1, 1 1/4	VG103T-16
	4 (102)	4 1/4 (107)	8350 (3800)	42.0 (19)	1 3/4	7/8	1 1/4, 1 1/2	VF104R-20	1 1/4	VF104T-20

FLANGED WHEELS (FW)

Capacities to 18,000 lbs.

Standard Features

- **Construction** - Cast iron or ductile alloy
- **Lubrication Fitting on Hub** (except 3 1/2 " size)
- **Machined Face And Flange** (except where noted)
- **Single Or Double Flanged**
- **Can Be Installed In Most Rigid Caster Rigs We Have Available**

Add bore or bearing size to part number
(Ex: FTWP - 1 7/16)



FTWR-8

Optional Features

- **Heat Treating For Extended Wear And Higher Capacities** - (Suffix -HT)
- **Special Machined Plain Bore Sizes** - See minimum and maximum available
- **Keyways** - (Suffix -KW)
- **Set Screws** - (Suffix -SS)
- **Sealed Bearings** - (Suffix -SW)

APPLICATIONS:

Excellent where mobile equipment needs to be rolled in a smooth controlled manner (production lines, etc.).
Excellent for mining, rail and furnace applications.

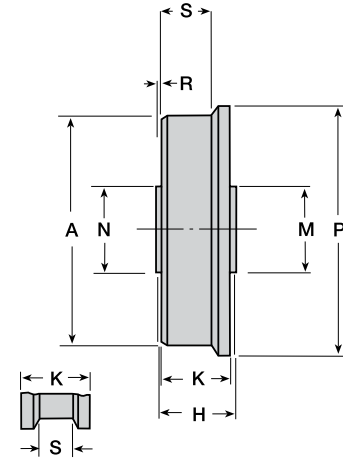

Excluding Flanges		Including Flanges		Hub		Load Capacity lbs. (KGS)	Approx. Shipping Weight lbs. (KGS)	Plain Bore			Straight Roller Bearings		Tapered Roller Bearings	
Dia. "A" Inches (mm)	Face "S" Inches (mm)	Dia. "P" Inches (mm)	Face "K" Inches (mm)	Length "H" Inches (mm)	Cored Hole Inches (mm)			Min. Inches	Max. Inches	Part Number	Sizes Inches	Part Number	Sizes Inches	Part Number
SINGLE FLANGED WHEELS														
3 1/2 (89)	1 7/16 (36)	4 1/8 (104)	1 7/8 (47)	2 1/4 (57)	1 1/4 (32)	500 (225)	5.0 (2.25)	1 7/16	2 3/16	FTWP-35	3/4, 7/8, 1, 1 1/8, 1 1/4	FTWR-35	3/4, 1	FTWT-35
4 1/2 (113)	1 5/8 (41)	5 1/2 (139)	2 3/8 (60)	3 1/4 (82)	Solid	3000 (1350)	13.0 (6.0)	1 3/16	2 7/16	FTWP-45	1, 1 1/8, 1 1/4, 1 1/2	FTWR-45	3/4, 1, 1 1/4	FTWT-45
4 15/16 (125)	1 7/16 (36)	5 11/16 (143)	2 1/4 (57)	2 3/8 (60)	7/8 (22)	1000 (450)	12.0 (5.5)	1	2 1/4	FTWP-51	3/4, 7/8, 1, 1 1/8, 1 1/4	FTWR-51	3/4, 1	FTWT-51
5 (127)	2 1/16 (52)	6 (152)	2 11/16 (68)	3 1/4 (82)	X	4200 (1890)	18.0 (8.0)	1 15/16	2 7/16	FTWP-5	1, 1 1/8, 1 1/4, 1 1/2	FTWR-5	1, 1 1/4	FTWT-5
6 1/8 (154)	1 11/16 (42)	7 (176)	2 3/16 (56)	2 3/4 (69)	7/8 (22)	2000 (900)	18.0 (8.0)	1 1/16	2	FTWP-6	3/4, 7/8, 1, 1 1/8, 1 1/4	FTWR-6	3/4, 1	FTWT-6
6 1/8 (154)	1 11/16 (42)	8 (203)	2 3/16 (56)	2 7/8 (72)	7/8 (22)	2500 (1125)	20.0 (9.0)	1 1/16	2 3/16	FTWP-61	1, 1 1/8, 1 1/4	FTWR-61	3/4, 1	FTWT-61
7 7/8 (200)	1 3/4 (44)	8 5/8 (207)	2 1/4 (57)	2 1/2 (60)	7/8 (22)	2500 (1125)	20.0 (9.0)	1	2 1/4	FTWP-8	3/4, 7/8, 1, 1 1/8, 1 1/4	FTWR-8	3/4, 1, 1 1/4	FTWT-8
8 (203)	2 1/4 (57)	9 1/2 (240)	3 (76)	3 1/2 (89)	1 3/4 (44)	3000 (1350)	24.5 (11.0)	1 15/16	3	FTWP-82	1, 1 1/8, 1 1/4, 1 1/2	FTWR-82	3/4, 1, 1 1/4	FTWT-82
8 7/8 (226)	2 1/4 (57)	10 1/2 (265)	2 5/8 (66)	2 1/4 (57)	7/8 (22)	2000 (900)	21.5 (9.6)	1	1 15/16	FTWP-9	3/4, 7/8, 1, 1 1/8, 1 1/4	FTWR-9	3/4, 1	FTWT-9
10 (254)	2 1/2 (60)	12 (302)	3 1/8 (79)	3 1/4 (82)	1 3/4 (44)	4000 (1800)	45.0 (20.0)	1 15/16	3	FTWP-10	1, 1 1/8, 1 1/4, 1 1/2	FTWR-10	1, 1 1/4	FTWT-10
14 (353)	2 3/4 (69)	15 5/8 (394)	3 5/16 (83)	3 1/2 (89)	1 1/4 (22)	3000 (1350)	48.0 (22.0)	1 7/16	2 1/2	FTWP-14	1, 1 1/8, 1 1/4	FTWR-14	1 1/4	FTWT-14
14 7/8 (378)	2 5/8 (66)	16 7/8 (405)	3 5/8 (91)	4 1/4 (107)	1 3/4 (44)	7500 (3375)	85.0 (38)	1 15/16	5	FTWP-15	1 1/8, 1 1/4, 1 1/2, 1 3/4, 2	FTWR-15	1, 1 1/4	FTWT-15
DOUBLE FLANGED WHEELS														
5 (127)	1 11/16 (42)	6 (152)	3 (76)	3 1/4 (82)	1 5/8 (41)	4200 (1890)	19.0 (8.5)	1 15/16	2 7/16	DFTWP-53	1, 1 1/8, 1 1/4, 1 1/2	DFTWR-53	1, 1 1/4	DFTWT-53
6 (152)	2 1/8 (54)	7 5/16 (184)	3 (76)	3 1/2 (89)	1 3/4 (44)	2500 (1125)	21.5 (9.6)	1 1/8	2 1/4	DFTWP-62	3/4, 7/8, 1, 1 1/8, 1 1/4	DFTWR-62	3/4, 1, 1 1/4	DFTWT-62
9 (229)	1 1/4 (32)	10 (254)	2 (50)	2 (50)	1 1/4 (32)	1500 (675)	19.25 (8.6)	1 3/8	1 15/16	DFTWP-91	3/4, 7/8, 1	DFTWR-91	3/4, 1	DFTWT-91
9 1/4 (233)	1 1/2 (38)	10 7/16 (263)	2 1/2 (60)	3 3/4 (95)	1 1/4 (32)	2500 (1125)	22.5 (10)	1 3/8	2 1/4	DFTWP-92	7/8, 1, 1 1/8, 1 1/4	DFTWR-92	3/4, 1, 1 1/4	DFTWT-92